



## 62 Berkshire Place Springfield Lakes QLD

4  2  2 

Sat high at the top of the street, freshly painted throughout with new carpets and landscaping this house is ready for your family to move in and enjoy. This home offers large under house storage and beautiful timber decks to relax and enjoy your surroundings.

- Large open plan living and dining area
- Large kitchen with dishwasher
- Family sized bathroom
- Three bedrooms upstairs with one bedroom located downstairs
- Two decked entertainment areas
- Fully landscaped gardens
- Elevated high set home
- 400m<sup>2</sup> Block
- Built in 2003

**Price** : \$ 408,000  
**Land Size** : 400 sqm  
**View** : <https://www.lavieps.com.au/sale/qld/ipswich-west-moreton/springfield-lakes/residential/house/5681013>

62 Berkshire Place, **Springfield Lakes QLD**

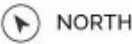

 x 4	 x 2	 x 2
Internal 177m <sup>2</sup>	External 35m <sup>2</sup>	Total 212m <sup>2</sup>

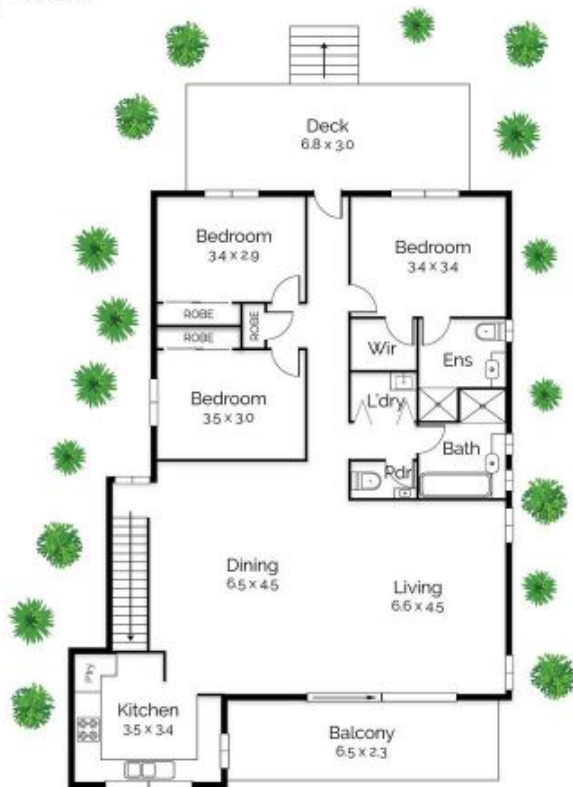

Floor Plan  
Upper Floor

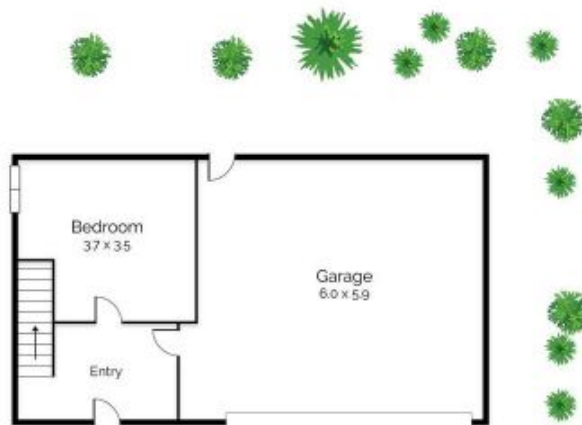

Floor Plan  
Lower Floor

**LaVie**  
property solutions

**Conditions of use:** All floor plan measurements, positions and angles are approximate and for illustrative purposes only. Hausable makes no guarantee as to the accuracy of any measurements, symbols or features as the intent of this floor plan is to indicate the approximate layout of the property only, and must not be relied upon for any other purpose, whatsoever. While every attempt at accuracy is made, potential buyers must seek their own independent professional measurements to determine the homes suitability before purchase. Hausable accepts no responsibility or liability for any loss, however arising, from the use of this floorplan. This floor plan must not be reused, or resold for any reason without prior written consent from Hausable Pty Ltd.