



23 Alfred Place Springfield Lakes QLD

5 🚗 2 🚗 2 🚗

Back in the days when homes were built large and yards could fit pools and swing sets and trampolines, families could grow in the same home without the need to keep upsizing, and the location is second to none for convenience to transport and a quiet family friendly cul de sac ? they don't make them like this anymore!

On a large 765m2 block at the top of the street, this spacious, flowing floorplan offers an awesome inside space, and also the king of outdoor spaces with a designer sparkling pool with dual waterfall walls and solar heating, and huge outdoor entertaining space including massive patio, fire pit seating area, double sized side access and a yard big enough for the kids and pets.

23 Alfred Place has all you could want:
 * An attractive brick and tile home with lovely street appeal

Price : \$ 605,000
Building Size : 280 sqm
Land Size : 765 sqm
View : <https://www.lavieps.com.au/sale/qld/ips-wich-west-moreton/springfield-lakes/residential/house/5681150>

23 Alfred Place, Springfield Lakes QLD



 x 4

 x 2

 x 2

Internal
250m²

External
30m²

Total
280m²

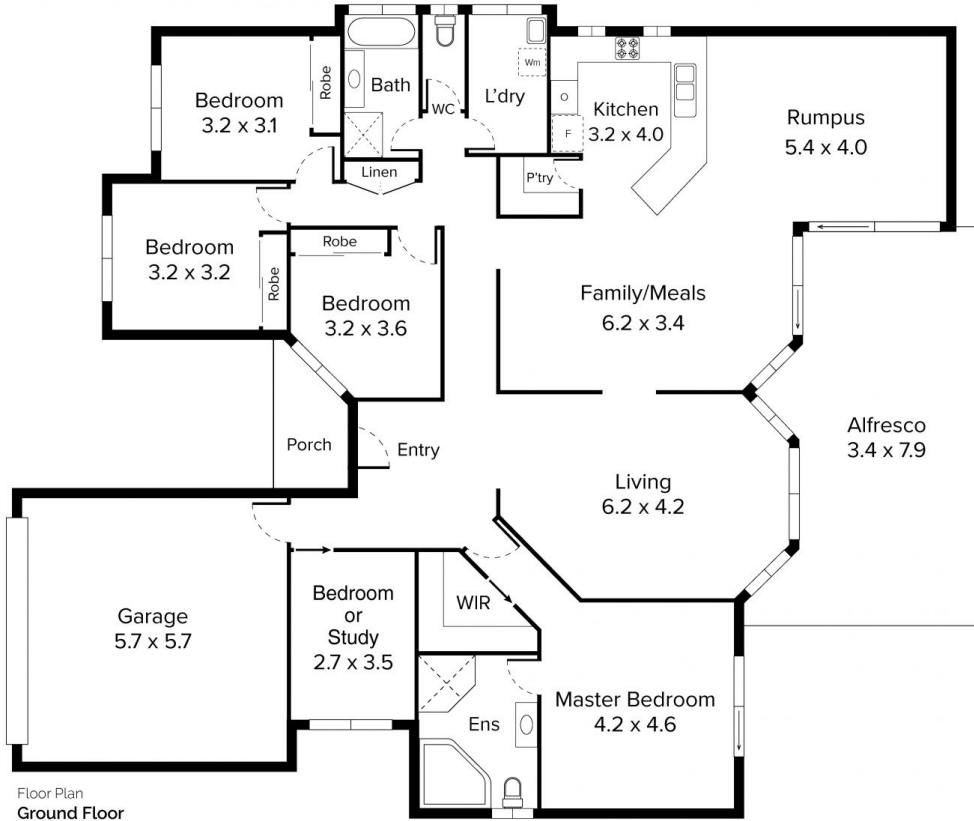

Floor Plan
Ground Floor

Conditions of use: All floor plan measurements, positions and angles are approximate and for illustrative purposes only. Hausable makes no guarantee as to the accuracy of any measurements, symbols or textures as the intent of this floor plan is to indicate the approximate layout of the property only, and must not be relied upon for any other purpose, whatsoever. While every attempt at accuracy is made, potential buyers must seek their own independent professional measurements to determine the homes suitability before purchase. Hausable accepts no responsibility or liability for any loss, however arising, from the use of this floorplan. This floor plan must not be reused, or resold for any reason without prior written consent from Hausable Pty Ltd.